

STEP 1

Put two base plates (B1) on the 6M screws.

Use two 30mm long screws on the sides
and 20mm long screws in the middle.

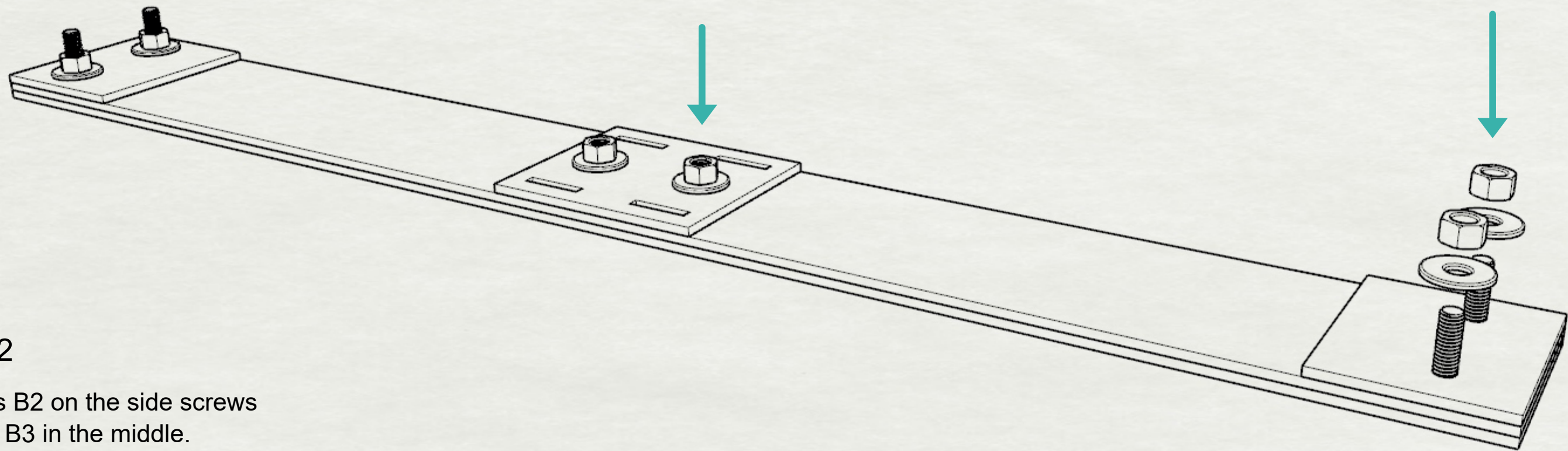

STEP 2

Put parts B2 on the side screws and part B3 in the middle.

Put the washers on all the bolts and tighten the nuts on each one.

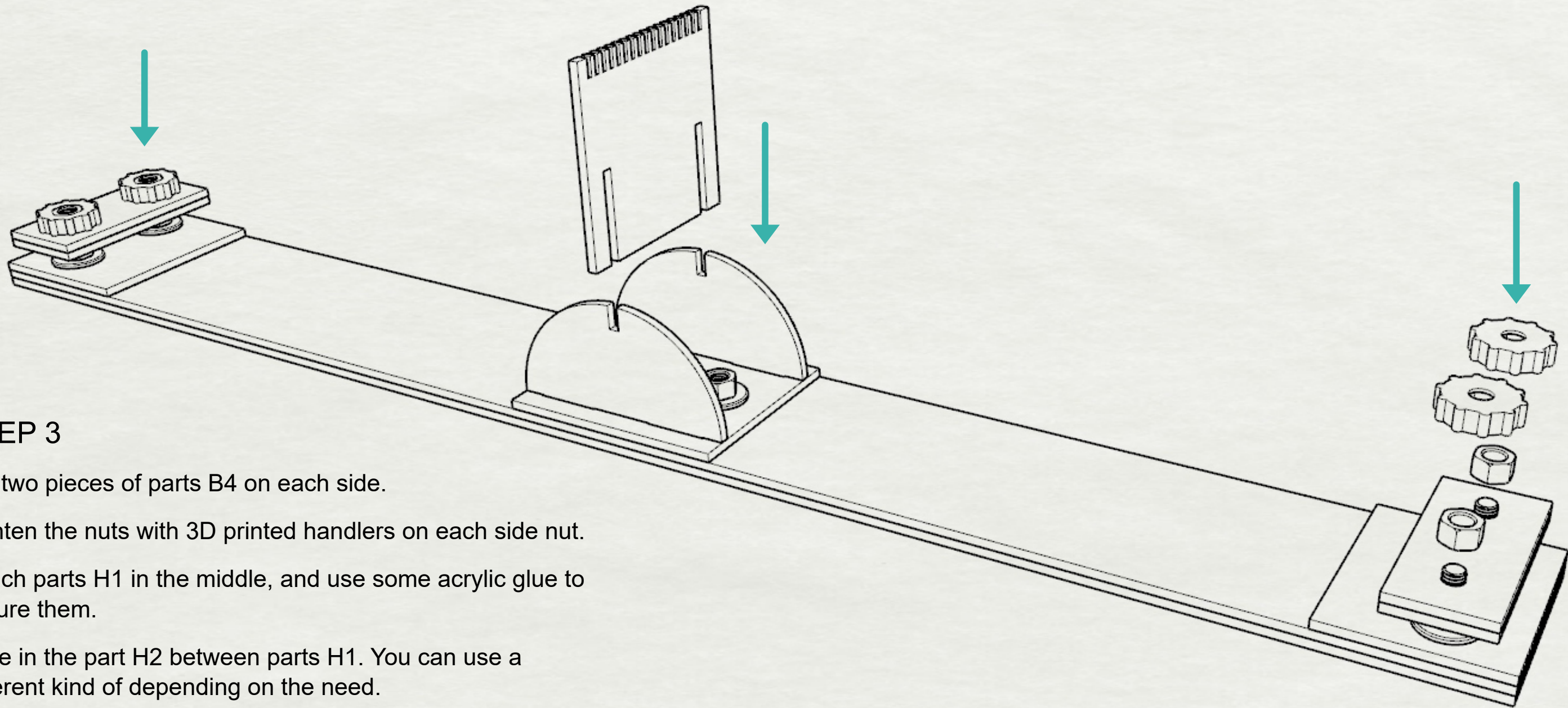

STEP 3

Put two pieces of parts B4 on each side.

Tighten the nuts with 3D printed handlers on each side nut.

Attach parts H1 in the middle, and use some acrylic glue to secure them.

Slide in the part H2 between parts H1. You can use a different kind of depending on the need.

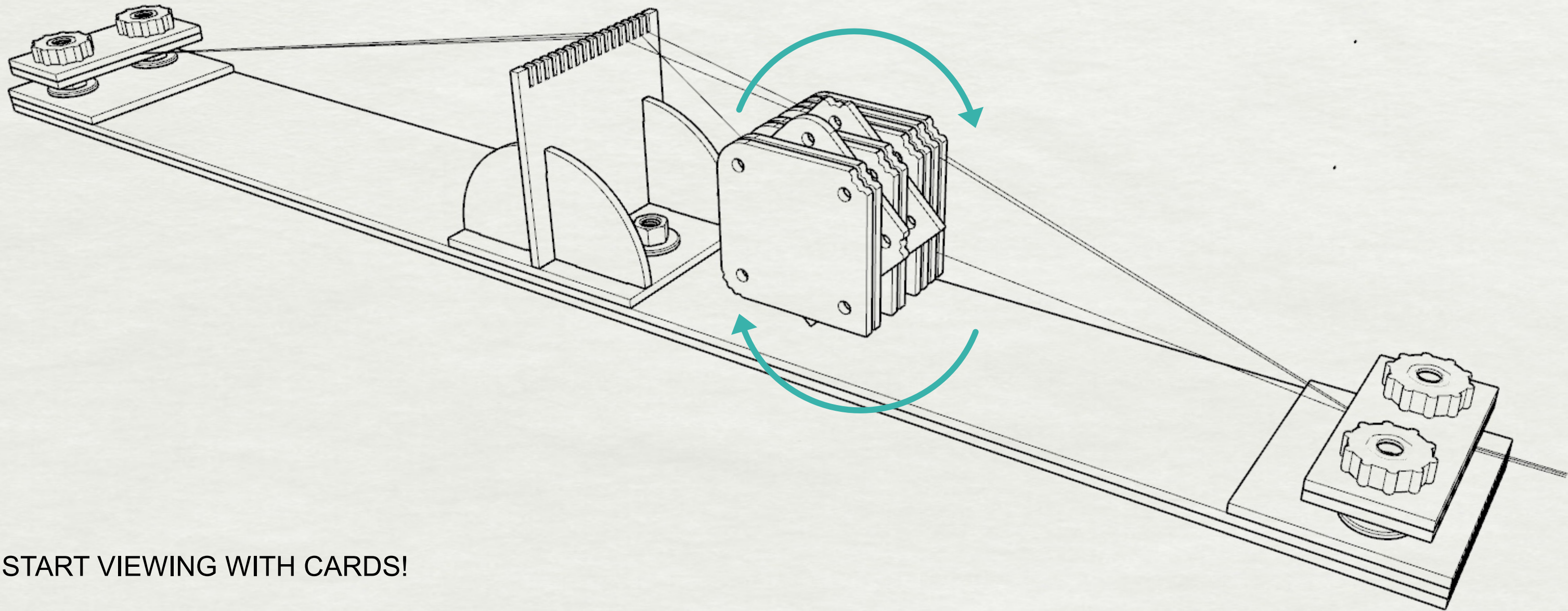

START VIEWING WITH CARDS!